

## Side DuraRac Installation Instructions

Ford Transit Med/ High Roof Full Size Van (129.9" or 147.6" Wheelbase)

Frame Kit Part Number CRC 22-1020-001

Revision 1.0 11/12/14

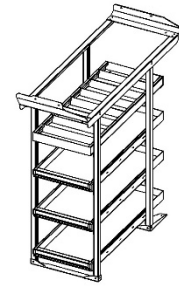

**STEP 1.** These instructions are based on having a van partition already installed. If not, install a partition prior to installing the side DuraRac.

**STEP 2.** Assemble the individual left & right side frames as shown if not supplied assembled in the frame kit. Check for squareness by measuring diagonally corner-to-corner. The baseplates will have to be bolted on once the frames are placed in the van since they connect the two frame sections across the bottom.

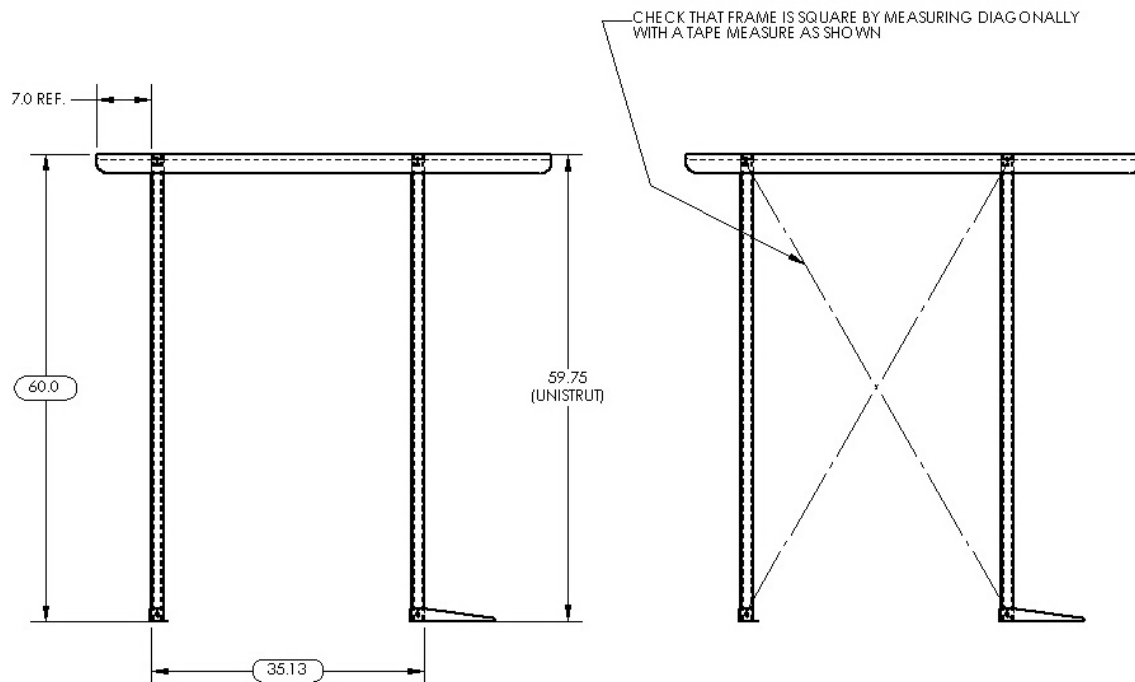

Figure 1: Side Frame Dimensions

**STEP 3.** Remove (2) factory tree fasteners on the roadside side wall as shown and install 1/4"-20 PlusNuts at these locations. Loosely install the roadside top brace using the supplied fasteners. The road (street) side top brace is identified by an 'S' on the part, and the curbside by a 'C' on the part. Loosely bolt the roadside top brace to the side frames using the supplied fasteners. All fasteners will be tightened once the baseplates have been secured.

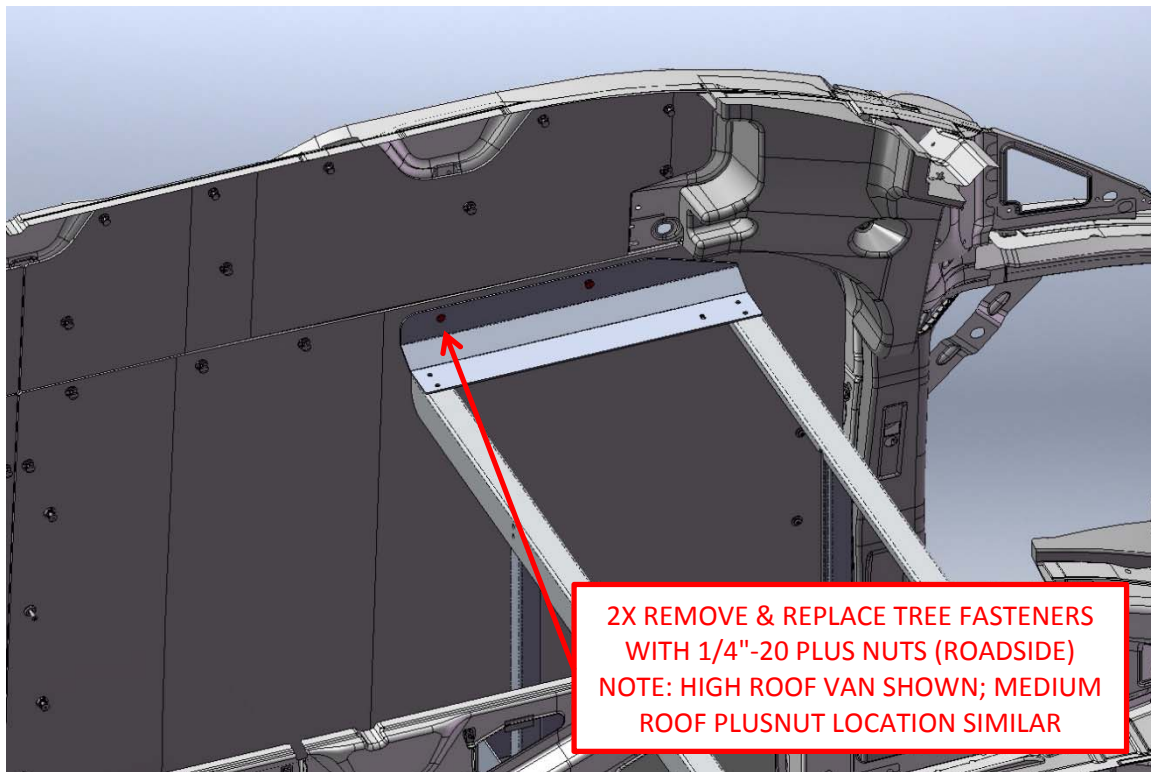

Figure 2: Roadside PlusNut Locations

**STEP 4.** Install (2) 1/4"-20 PlusNuts at the square hole locations over the curbside sliding door opening. Note that there are two sets of square holes on the high roof, and one set on the medium roof. In all cases the lowest set of square holes are used. Loosely install the curbside top brace using the supplied fasteners. Loosely bolt the curbside top brace to the side frames using the supplied fasteners.

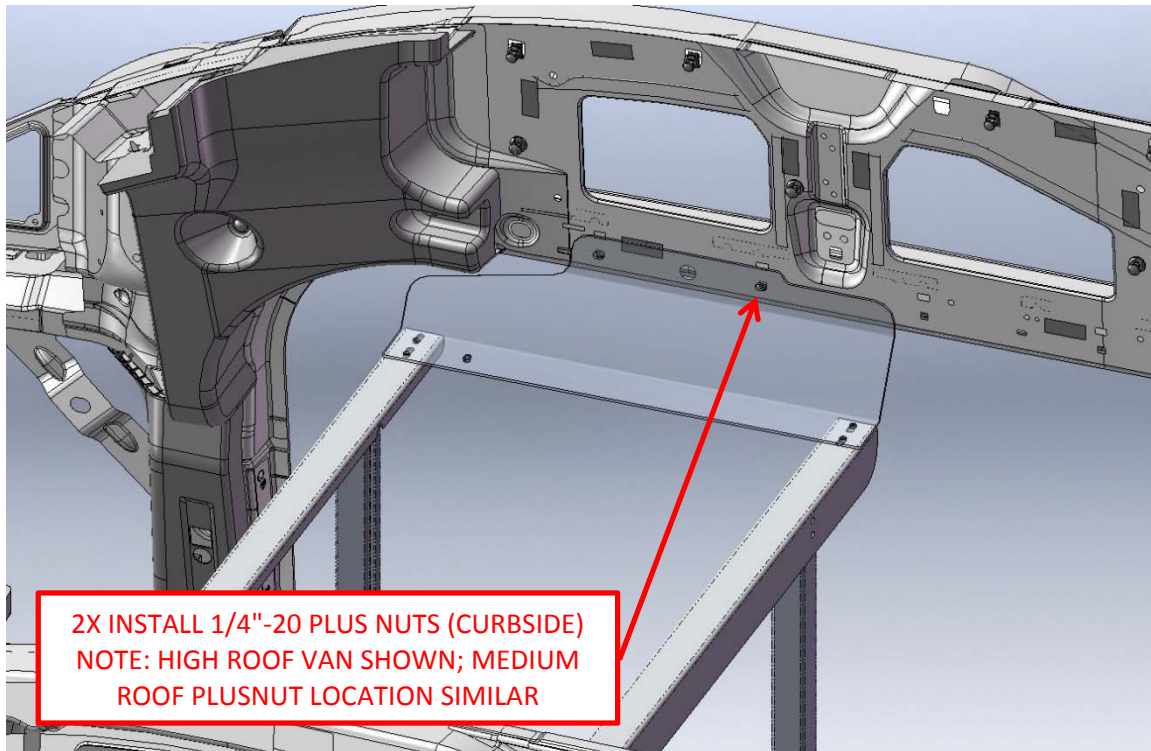

Figure 3: Curbside PlusNut Locations

**STEP 5.** Install the baseplates to the frames using the supplied fasteners. The curbside frame is identified by a 'C' on the baseplate, and the road (street) side by an 'S' on the baseplate.

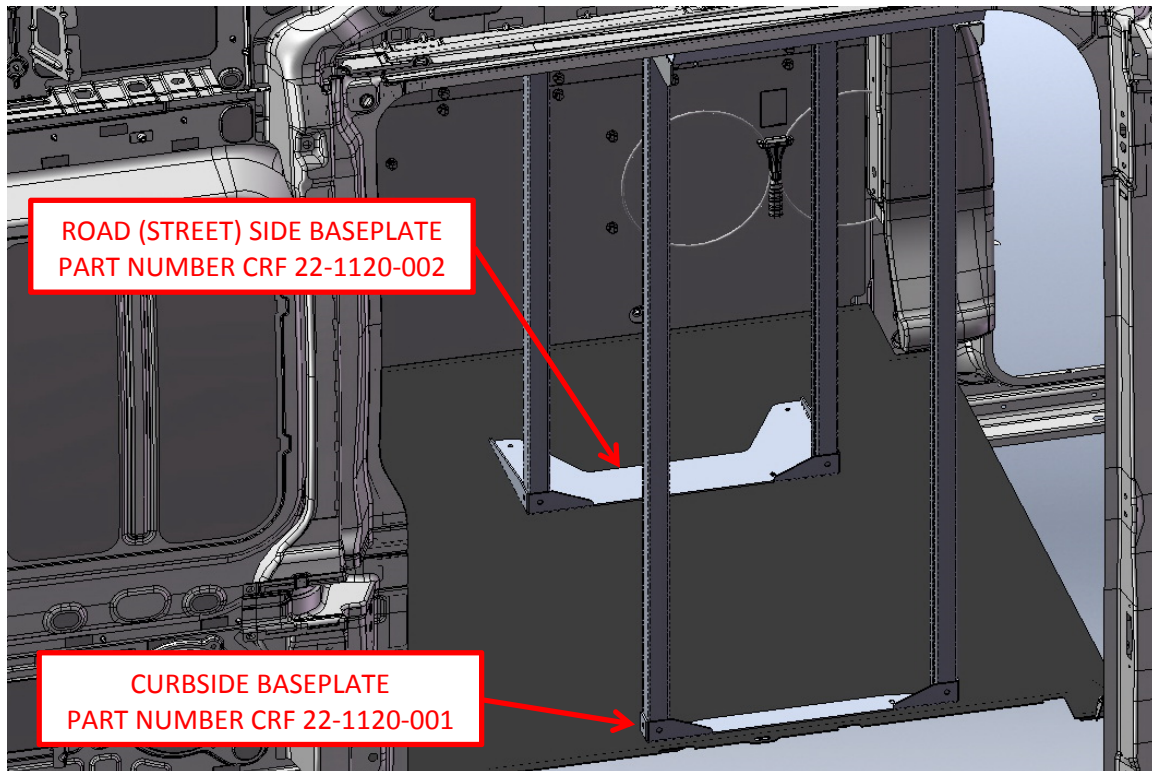
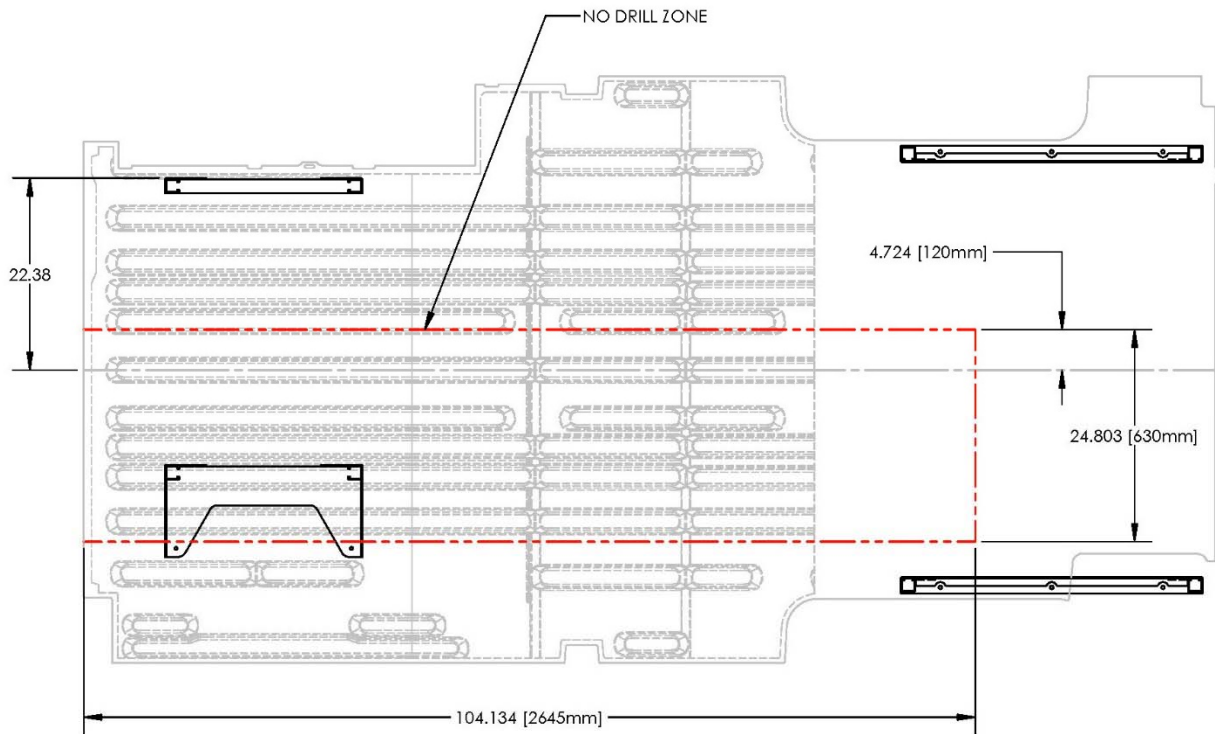

Figure 4: Baseplate Attachment

**STEP 6.** Curbside baseplate is to be up against the side door sill, and 12" in from the corner of the wheel well trim as shown. Check for critical frame width dimension (**19-5/8"**; shown in Figure 7), and then mark holes for drilling. Shift the frames off to the side (no need to unbolt the top braces) for drilling purposes. Use a 1-1/8" hole saw (teeth removed preferable) to drill the floor mat only for 1" OD x .38" ID spacers. Drill holes for the supplied 5/16" fasteners through the 1/4" pilot holes made by the hole saw. Install spacers and then secure baseplates using the supplied 5/16" fasteners. Tighten all top brace fasteners. Re-check critical width dimension and check for overall frame squareness by measuring diagonally corner-to-corner. Adjust if necessary.



**SIDE NOTE:** There is a significant no-drill zone identified by ford that runs up the center of the cargo area. The road (street) side base plate has been designed to avoid drilling any holes in this area. Dejana does not endorse any alternate locations for a side DuraRac due to the fact. Refer to Figure 5 for details.



**Figure 5: No-Drill Zone**



Figure 6: Curbside Baseplate Location Reference

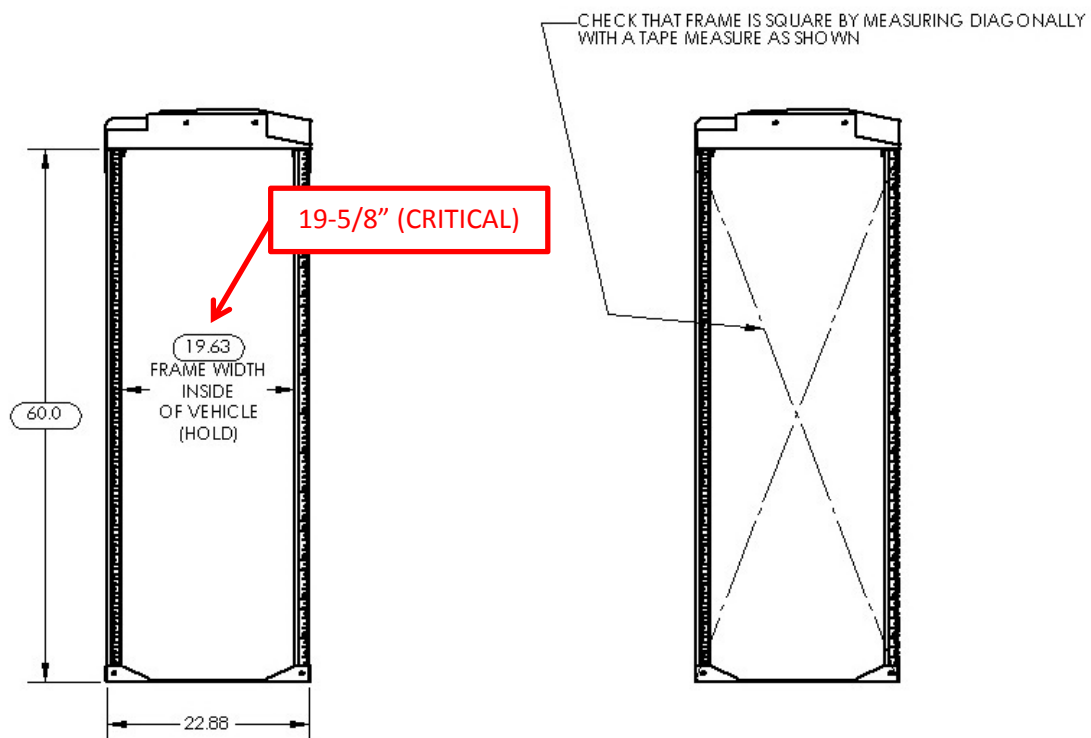

Figure 7: Critical Frame Width Dimension

**STEP 7.** Install the DuraRac drawers. Drawer size/ selection may vary by individual package configuration, but are all installed in the same manner. Drawers heights may be customer specified, or can be set at a reasonably practical arbitrary height. As follows:

- a. Insert the strut nut assembly into the strut channel and snug down 1/4"-20 hex bolts with the supplied wrench. Align all (4) strut nut inserts vertically.
- b. Extend drawer slides fully to the lock out position. Once in position this will allow access to the predrilled holes in the slides. Using supplied #10-32 x 5/8" pan head screw securely attach slides to inserts (see detail). Please note that this is a two-man operation.
- c. Close drawer and re-check that drawer is at desired height. Finish tightening the 1/4"-20 hex bolts to 80 in-lbs.
- d. Install additional drawers as required.
- d. Check all drawers for proper operation, and that they lock in both the open and closed positions. Adjust if necessary.



Figure 8: Typical Installed side DuraRac (drawer selection may vary by package)