

Nissan NV200 Rear Katerack Installation (drill free; uses OEM attachment points)

1. Assemble standard CRC 17-1000-001 Katerack frame kit if not shipped assembled, and check for square prior to installation in the vehicle
2. The frames bolt to the OEM attachment points shown below using metric fasteners (may or may not be a floor mat present)
3. If the floor mat is present, cut small slits to allow access to OEM attachment points for securing the baseplates



Figure 1: Attachment Points

4. Baseplates bolt to floor using metric fasteners (M8 OEM bolts will have to be removed and replaced with longer ones)

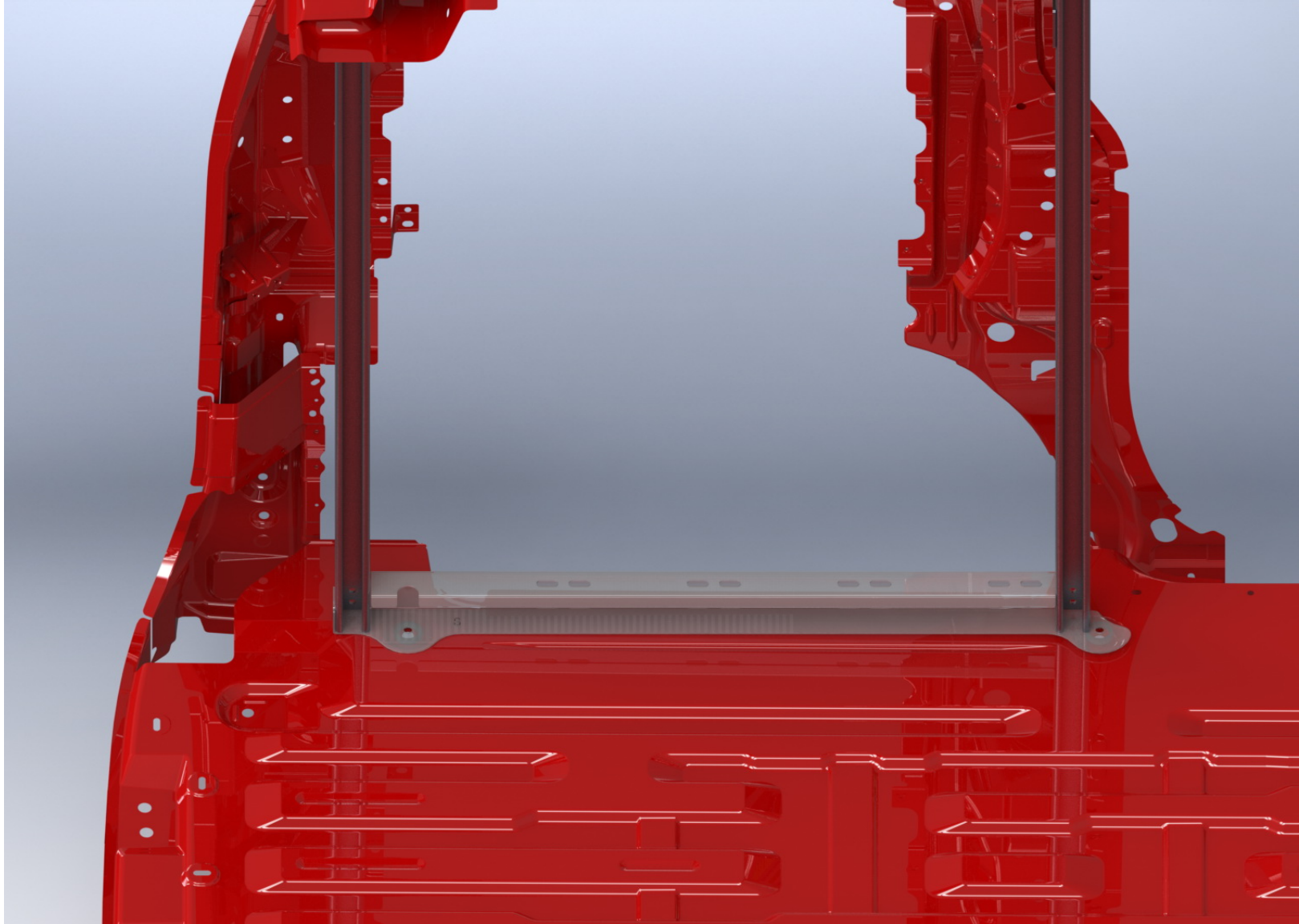

Figure 2: Baseplate Attachment

5. NSK RM560143-1 floor spacers are installed in the attachment wells in floor

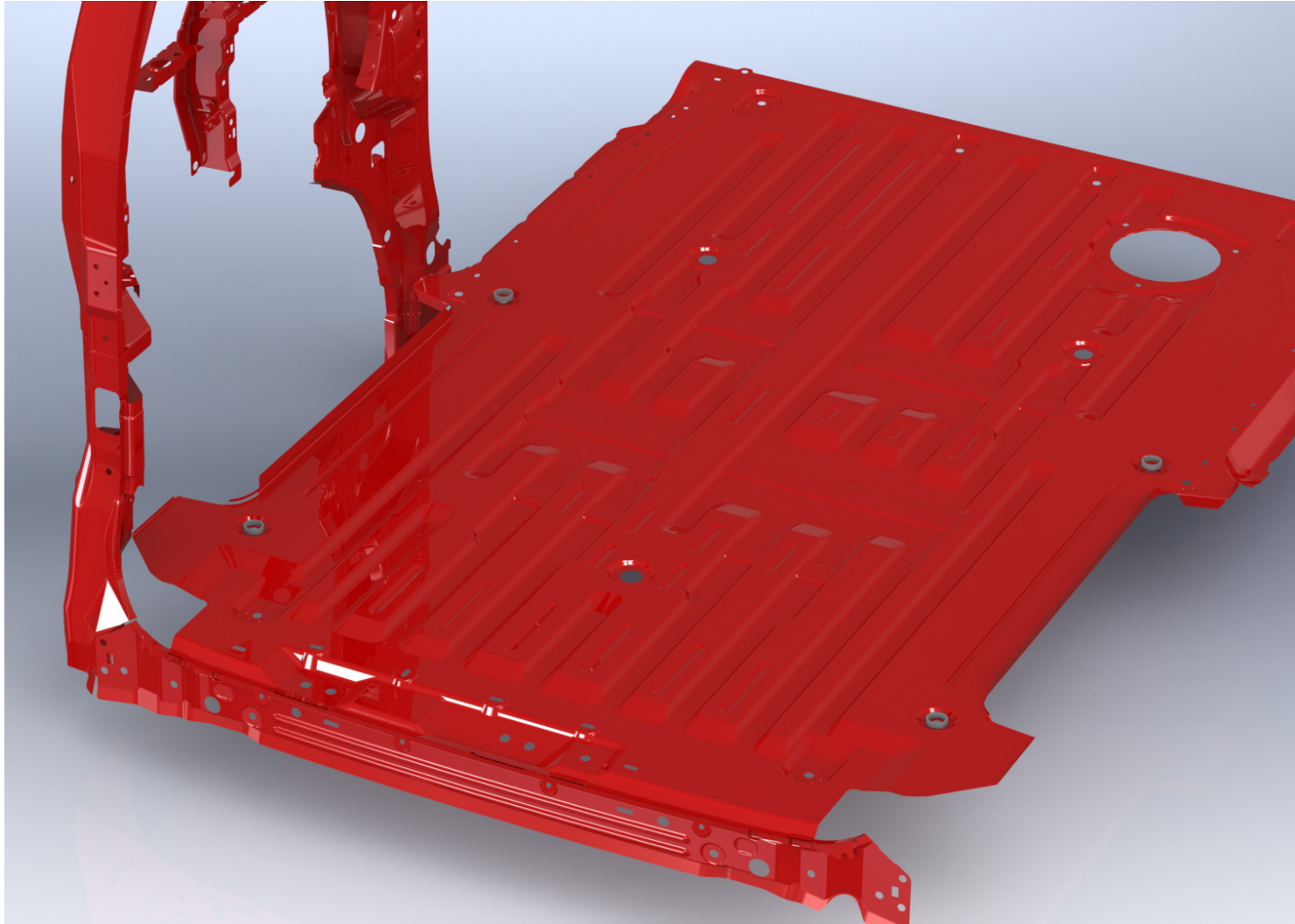

Figure 3: Floor Spacers

6. Upper forward (cab side) brackets are installed as shown using metric fasteners (drawers are to be installed before final bolting of brackets to Unistrut)

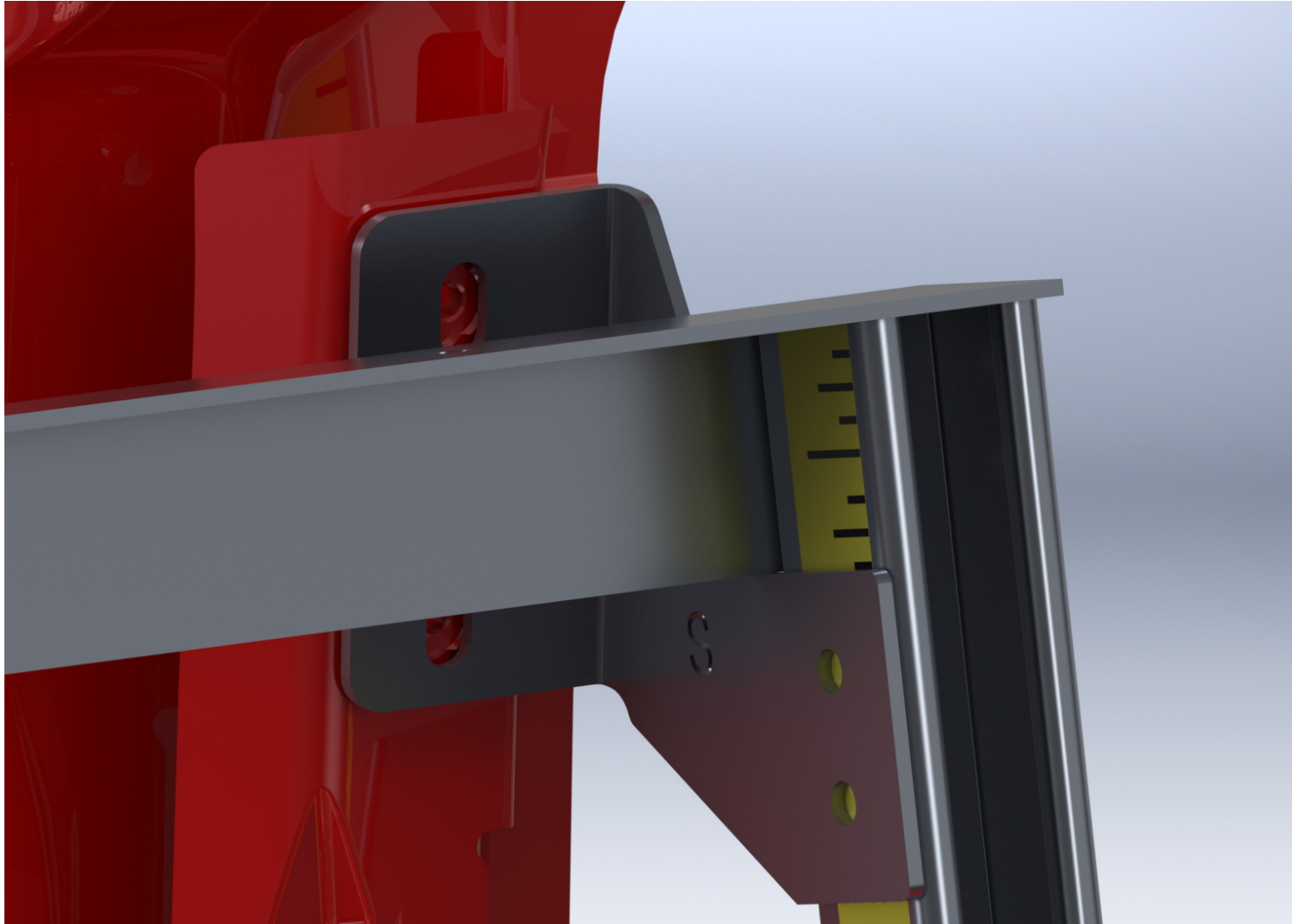

Figure 4: Upper (cab side) Brackets

7. Upper aft (cargo door side) brackets are installed as shown (drawers to be installed before final bolting of brackets to Unistrut)

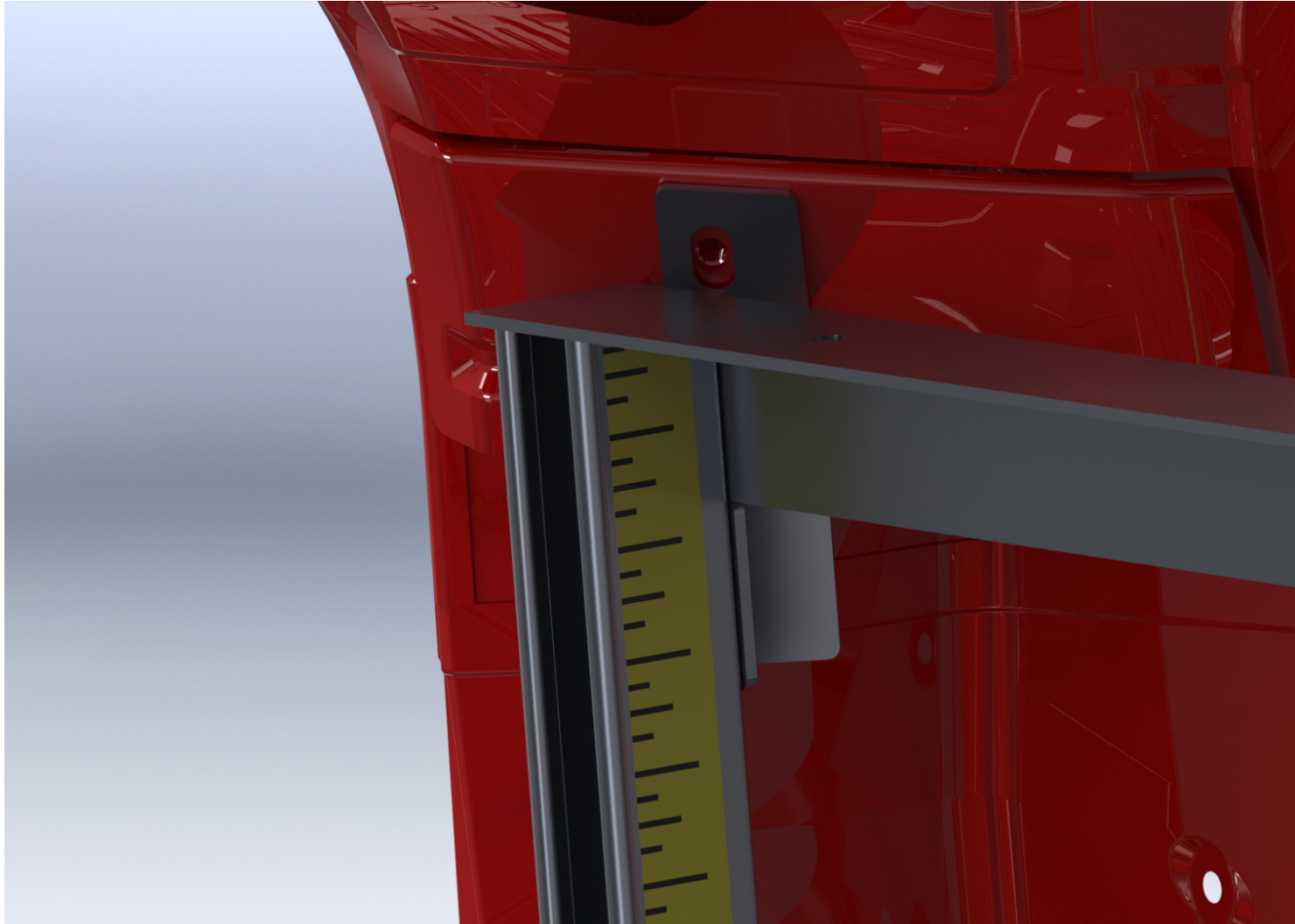

Figure 5: Upper (cargo door side) Brackets



Figure 6: Katerack with Drawers Installed (rear doors not shown for clarity)

NOTE: Check for 44.375" space in between Katerack Unistrut uprights prior to installing drawers



Figure 7: Installed Katerack (baseplate as shown from driver's side doorway)



Figure 8: Driver's Side FWD Upper Mount Bracket Shown Installed



Figure 9: Driver's Side AFT Upper Mount Bracket Shown Installed (will be a snug fit against rear pillar)



Figure 10: Installed Rear Katerack