

## Shelf Adjustment Instruction

**Required Tools:** 7/32" Allen wrench

**Assistance required:** Yes, two persons required

Please refer to the supplied installation instructions for an additional reference. The countersunk screw and spring nut used to retain the slides in places can be seen below.



Figure 1. 3/8"-16 Countersunk screw and spring nut

Follow these steps to adjust the shelves after the initial installation:

1. Slowly extend drawer until it is in the fully extended position and the slide mechanisms are locked in place. Once the drawer is in this position, it will allow access to all four flat head socket set screws (shown in Fig.1 above). Assistance is required to adjust the drawers. (One person should position oneself outside the van holding the extended drawer while the second person positions his/herself inside the van to adjust the slides.)

***DO NOT LOOSEN THESE SCREWS WITHOUT TWO PERSONS SUPPORTING THE DRAWER.***

2. With the drawer supported in this manner, loosen the countersunk screws at the rear of the Katerack (closest to the front of the vehicle), and adjust the rear of the drawer to the desired height and tighten them lightly.

3. Proceed to loosen the countersunk screws at the front of the Katerack (closest to the rear doors), and adjust the front of the drawer to the desired position.

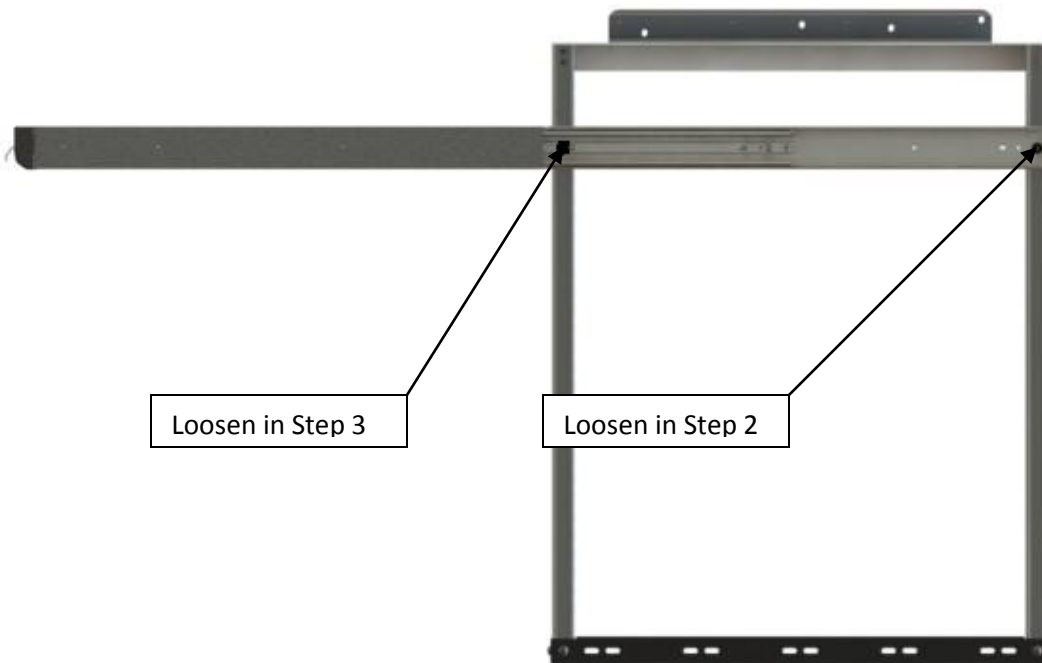

Figure 2. Side view of Katerack w/ drawer extended

4. Once in this position, it is imperative that the level of the drawer be checked. (If you do not ensure the parallelism of the drawer slides, they will deteriorate and fail at an above average rate. Also, unparallel drawer slides may result in improper function of the Katerack drawer i.e. not locking in extended or closed position, or unsmooth operation.)
5. Tighten countersunk screws to 19 ft/lbs.
6. Adjust any additional drawers in the same manner.